

BPW Brake Boosters and Spring Brakes

When fitting Brake boosters to your BPW axles, or indeed to any other axles the following installation instructions must be followed:

- ⦿ The **contact surface** of the booster bracket must have a surface planarity (the flatness of the surface) **of 0.4mm** – this is required for the booster to operate correctly.
- ⦿ The booster brackets may only receive a **thin layer** or **coat of primer paint** before the boosters are installed. The paint thickness may not exceed **100µm (100 microns)** – any thicker and the booster cannot be tightened correctly.
- ⦿ If use is to be made of the 120mm, 150mm or 180mm hole in the BPW automatic slack adjuster then the booster must be fitted with a **long clevis** – that is one with an **internal dimension of at least 40mm**.
- ⦿ Ensure the booster is fitted to the **correct hole in the booster bracket** – the one that **corresponds to the required hole in the slack adjuster**. See drawing for more details (Fig. 2).
- ⦿ The attachment nuts **must be torqued to 180Nm** to ensure correct fitment of the booster. Failure to torque the nuts to the correct torque setting will result in **damage to both the booster and the mounting bracket**.

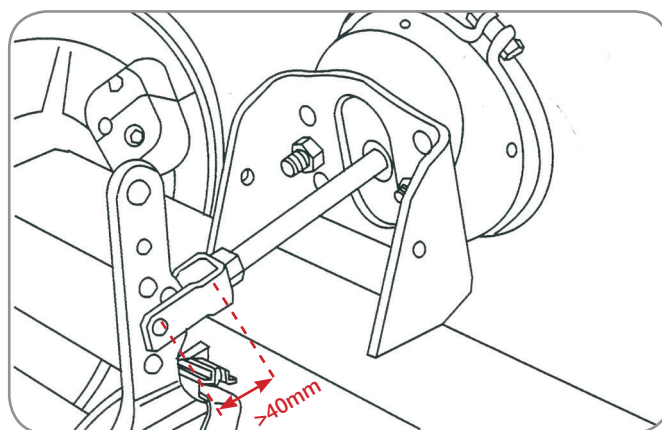

Figure 1

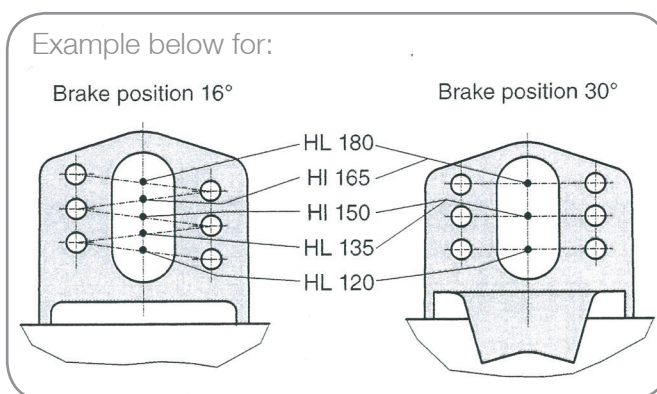

Figure 2

Note: We recommend only installing one brand of brake cylinders to any particular vehicle.

Victoria (Head office)

1-11 Cherry Lane,
Laverton North Vic 3026

Phone (03) 9267 2444

Fax (03) 9369 4826

New South Wales

10 Squill Place,
Arndell Park NSW 2148

Phone (02) 8811 7000

Fax (02) 8811 7050

Queensland

10 Bernoulli Street,
Darra Qld 4076

Phone (07) 3217 0877

Fax (07) 3217 0230

Western Australia

1021 Abernethy Road,
High Wycombe WA 6057

Phone (08) 9454 4000

Fax (08) 9454 4111

1300 651 652

info@bpwtranspec.com.au

bpwtranspec.com.au