



05/2021 10090621a

Drivers Manual



WARNINGS

2



Pinch point!



General warning

SYMBOLS



Driver's manual



Workshop



Lubricating points



Open/unlocked



Closed/locked



Visual check



Connection



Disconnection



If anything does not operate as described in the instructions, stop driving with the trailer immediately and contact a workshop.

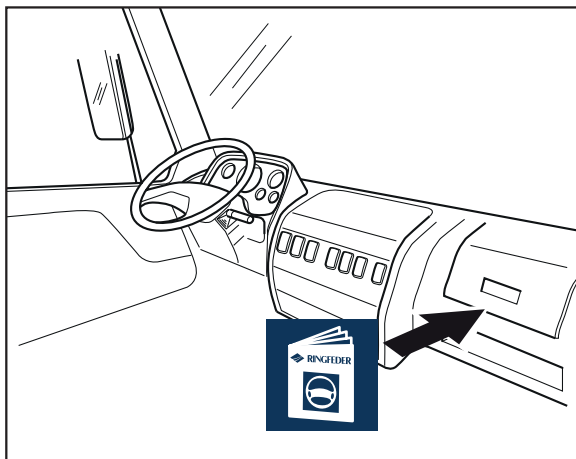

HANDLING

INSPECTION



Check the coupling equipment as described in the instructions. If the safety checks show that any of the wear limits have been exceeded, or that the functionality of the coupling has been impaired, servicing must be carried out immediately.



If the coupling equipment does not operate as described in the Driver's Manual, drive to a workshop for repair. If the coupling will not enter the locked position after

repeated attempts, stop driving with the trailer immediately and contact your nearest workshop for trouble shooting and corrective measures.

Jackknifing is seen as a very serious collision between a vehicle and trailer. If jackknifing occurs, equipment such as the coupling, drawbar, endplates, drawbeam, etc., must be dismantled and carefully examined, and replaced if damage is suspected.

Coupling with jackknife warning alarm must be checked and adjusted/replaced as required.

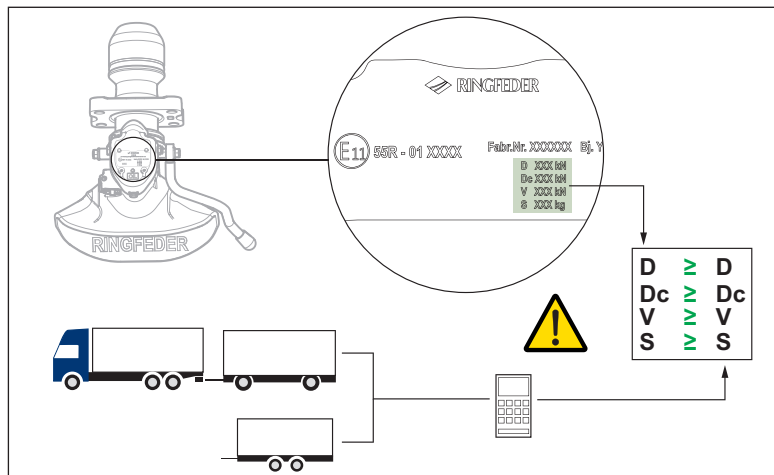

Only drawbar eyes that comply with the specified standard may be used together with Ringfeder's coupling programme to ensure the correct angular displacement. Drawbar eyes that do not comply with the standard can cause damage to the coupling.



In addition to the intervals listed, coupling equipment must always be checked in traffic situations such as reversing, collision, leaving the road or jack-knifing as a result of over loading. If there is any doubt regarding damage or overloading, the coupling equipment must be replaced.



Ringfeder's pneumatic equipment must NOT be operated via electrically controlled valves because there is a risk of electrical faults causing incorrect control of the air flow.



NOTE: Before beginning work with power-assisted equipment, the supply air must be switched off.

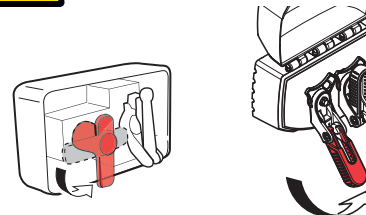

GENERAL INFORMATION

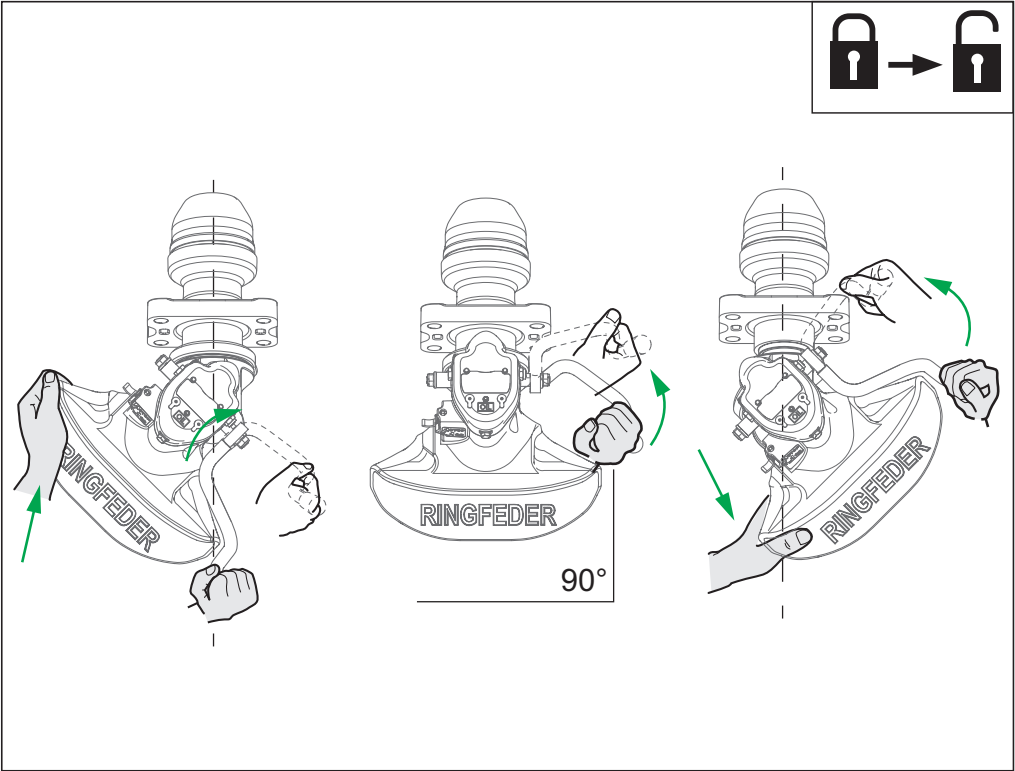
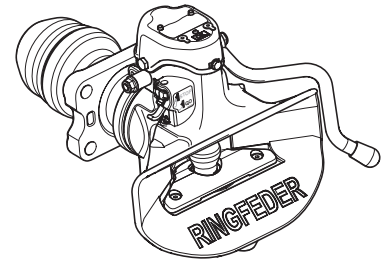
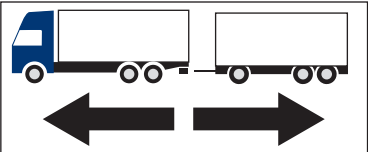
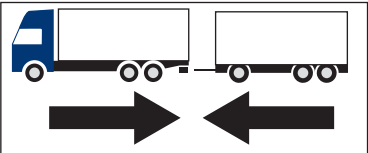

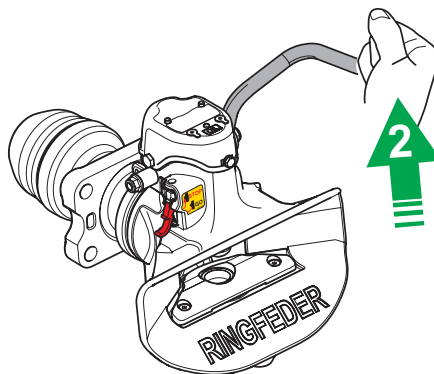
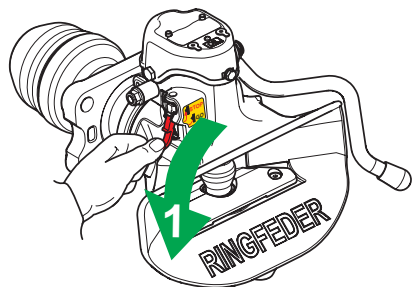

1

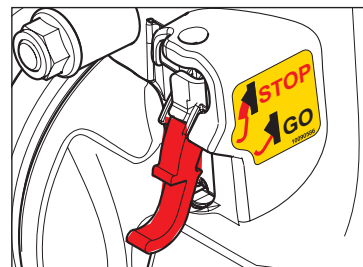
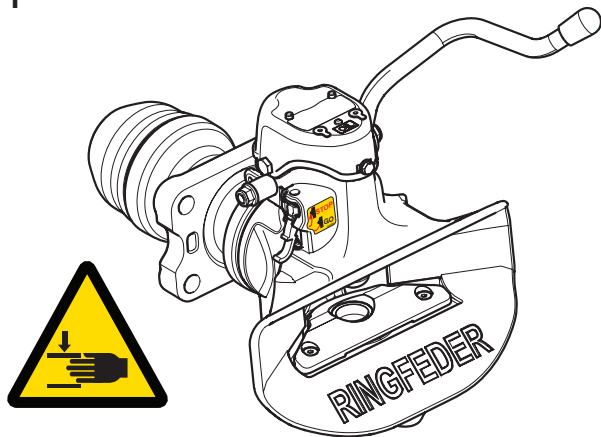

2

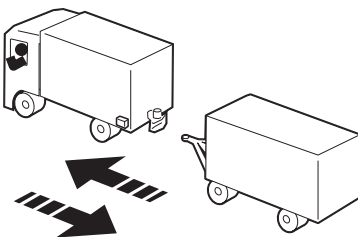

7

3

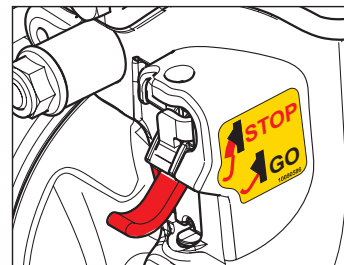
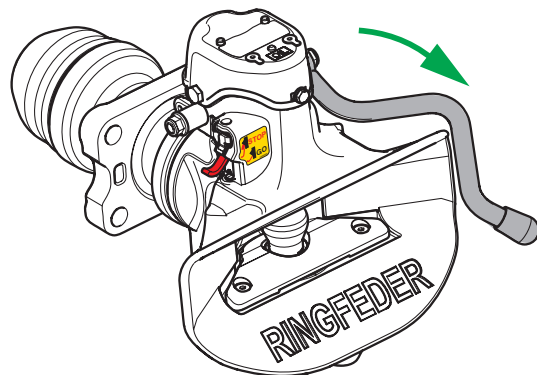

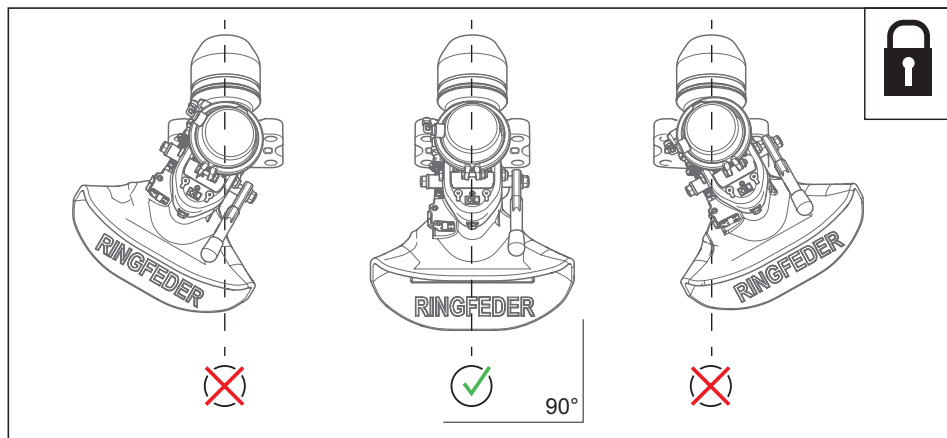
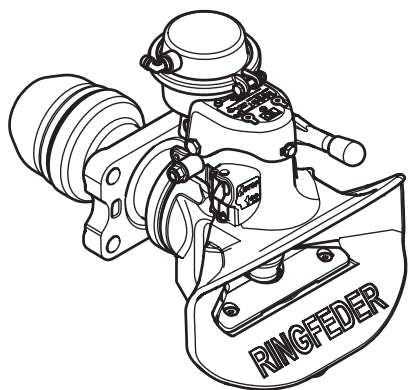
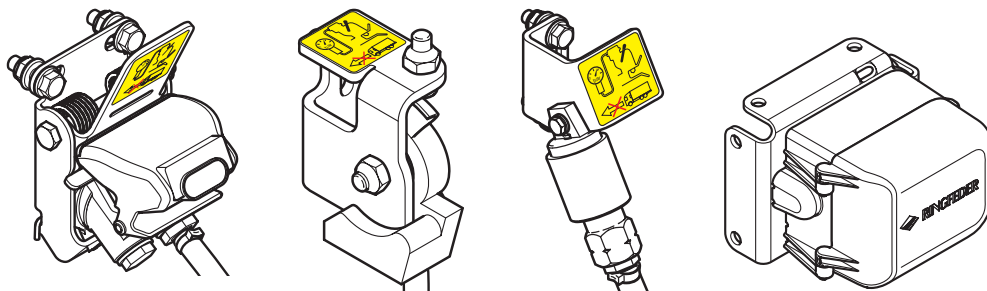
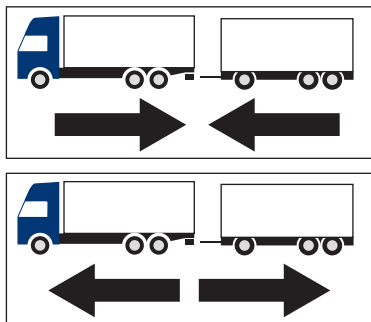

Duomatic

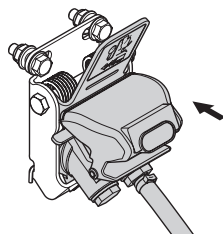
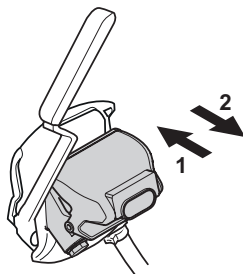
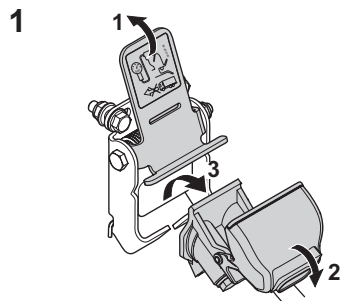

Palm

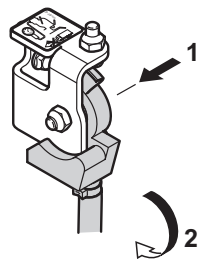
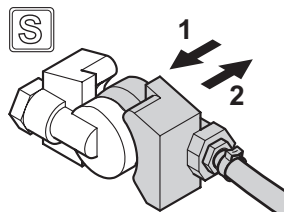
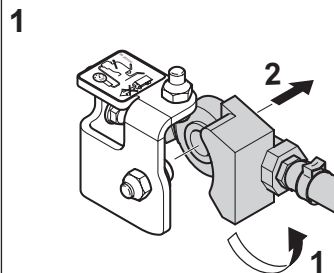

C-Coupling

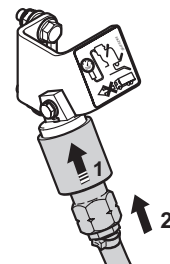
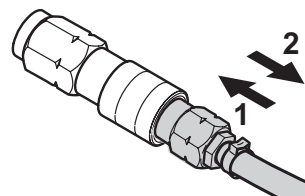
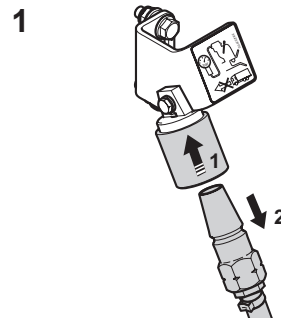

1

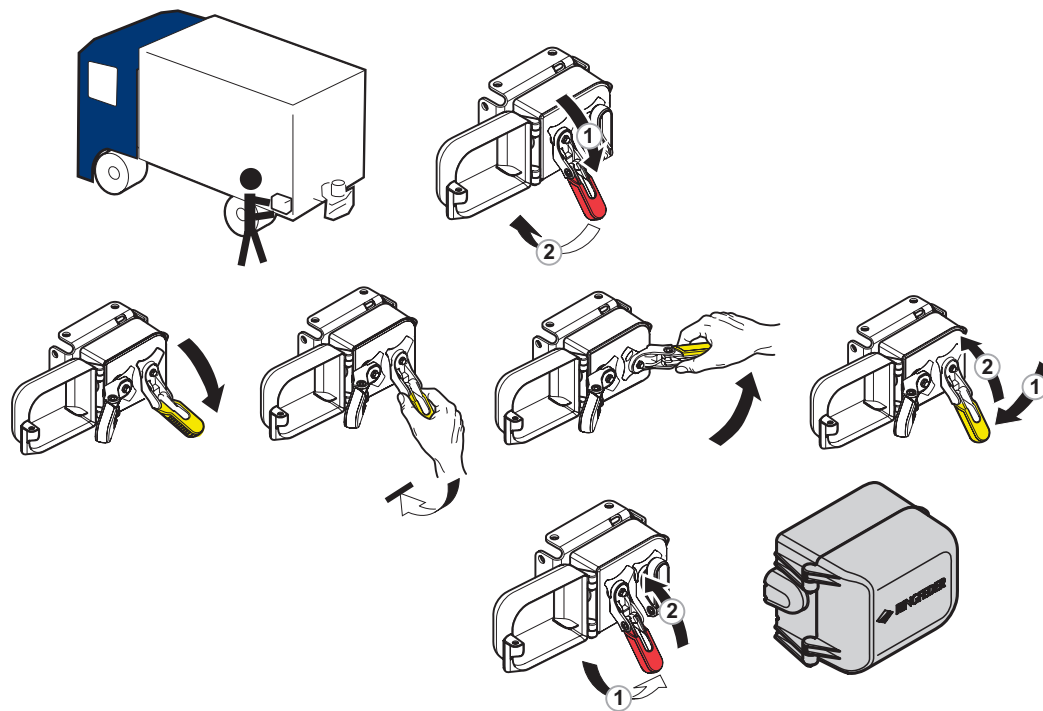

2

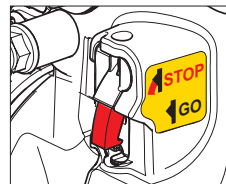
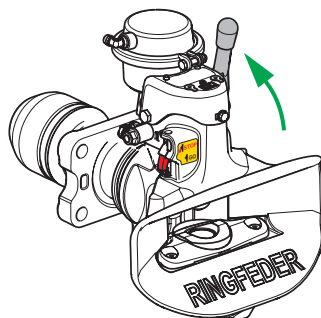

3

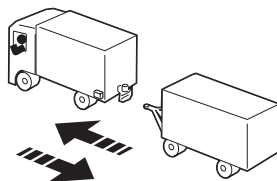

4

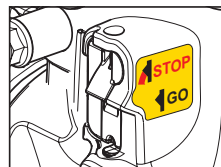
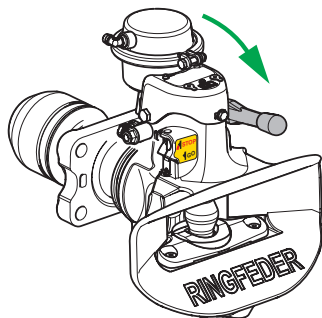

Locking indication

- when accessories are used

12

2

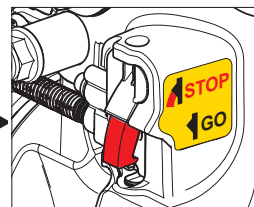
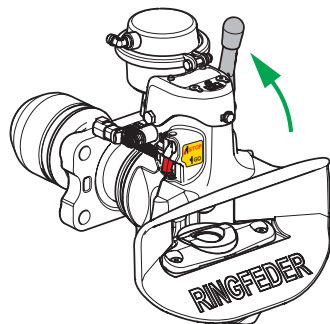

2a

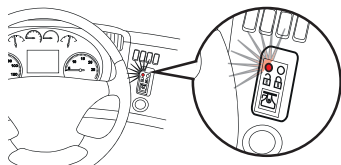

2b

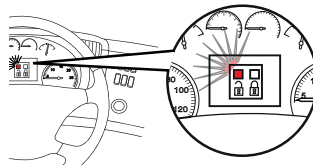

2c

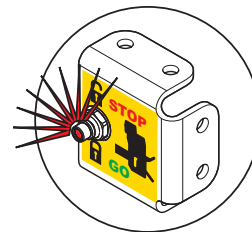
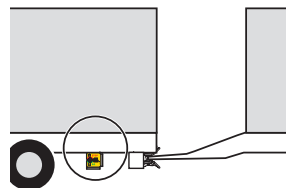

3

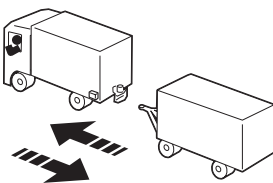

4

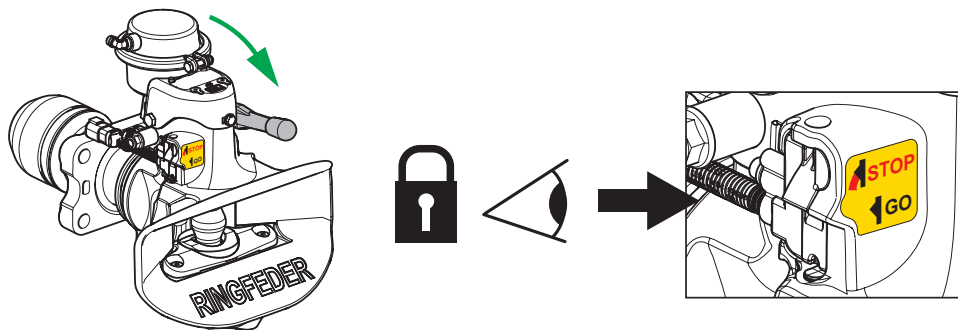

13

4a

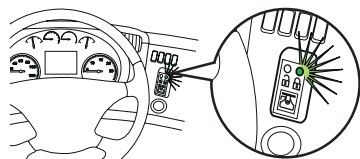

4b

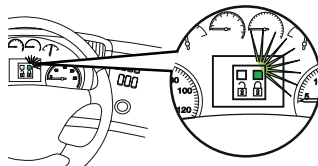

4c

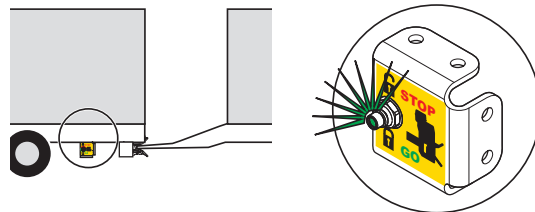

INSPECTION AND SERVICE REQUIREMENTS

14

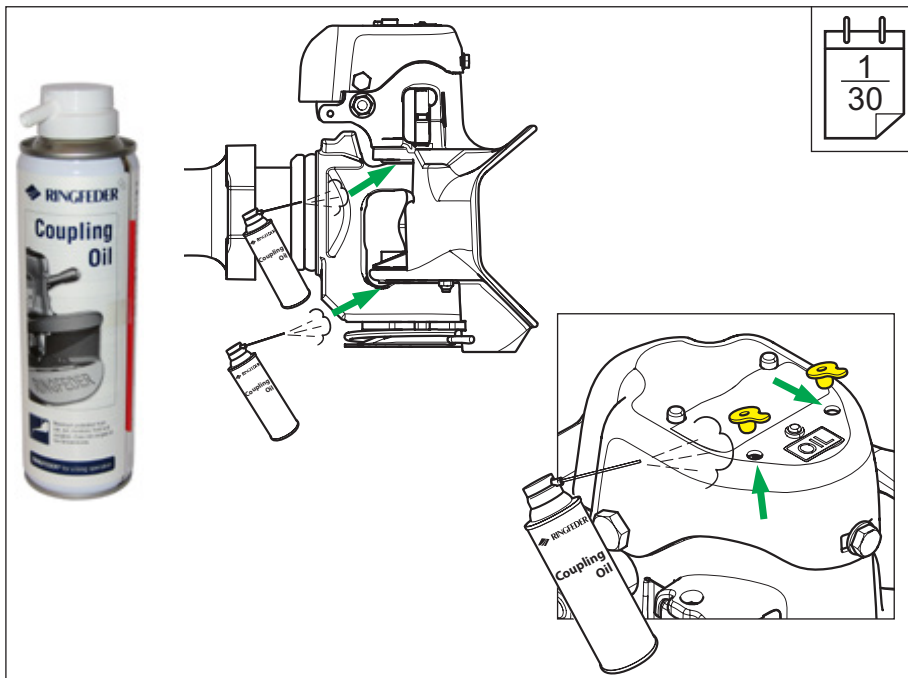

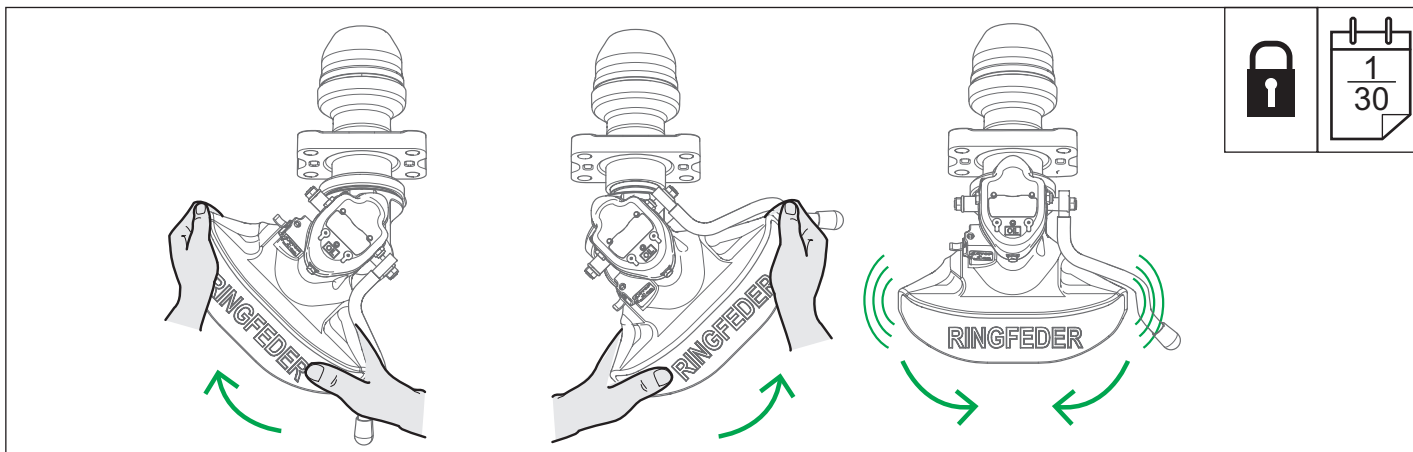

15

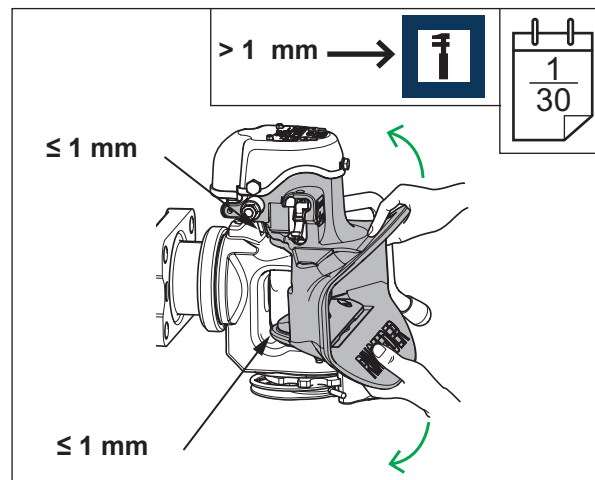
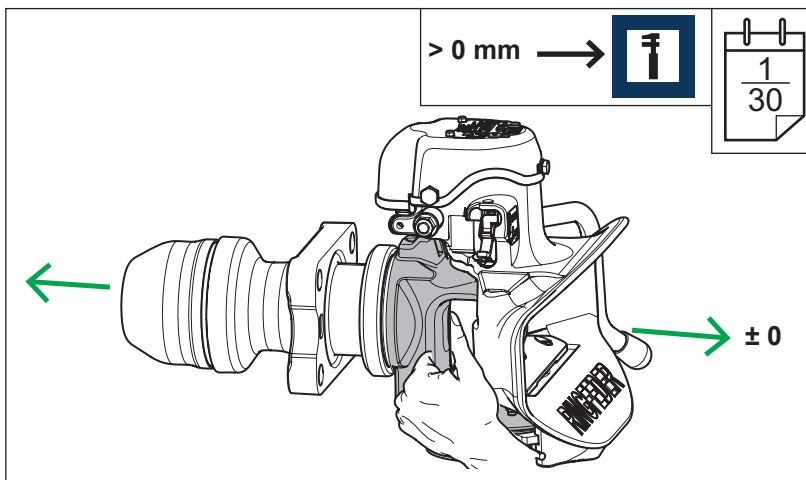

> 1 mm →

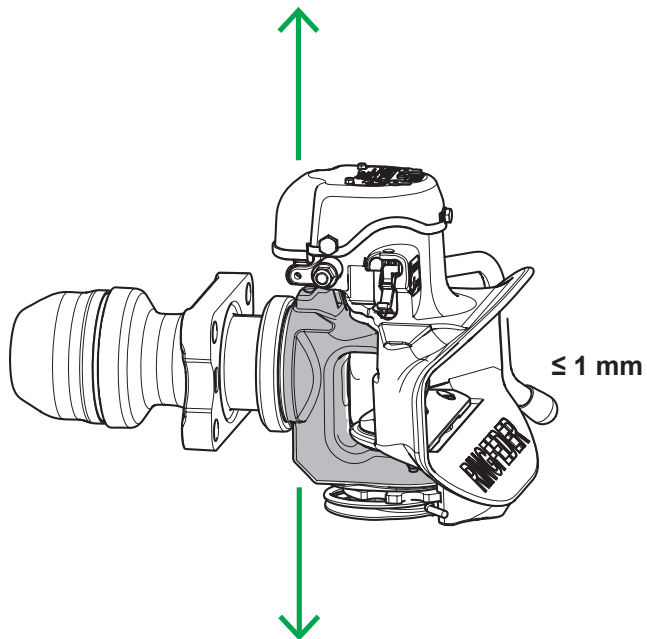
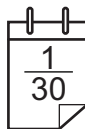

> 31,5 mm
> 36,5 mm →

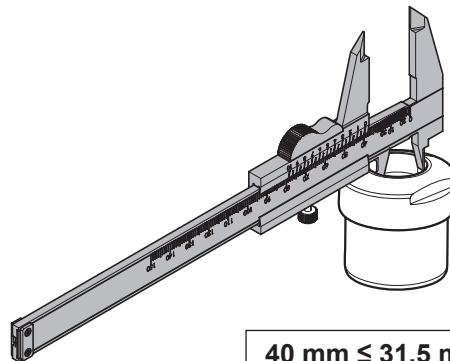
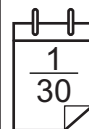

40 mm ≤ 31,5 mm
50 mm ≤ 36,5 mm

< 36,5 mm
< 46,5 mm

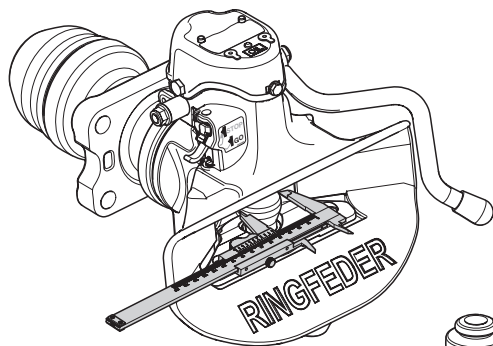
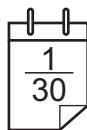

40 mm \geq 36,5 mm
50 mm \geq 46,5 mm

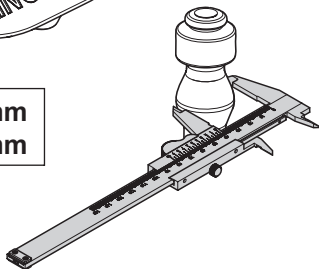

> 4 mm
> 5 mm

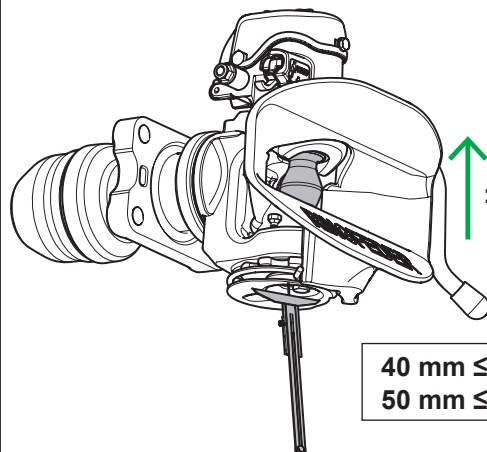
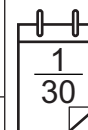

$\leq 4 / 5$ mm

40 mm \leq 4 mm
50 mm \leq 5 mm

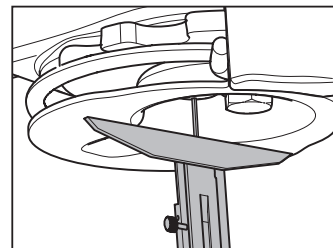

> 2,5 mm →

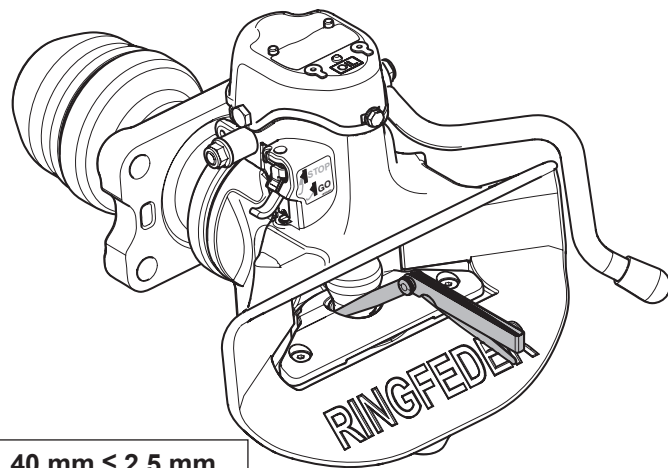
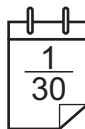

40 mm ≤ 2,5 mm
50 mm ≤ 2,5 mm

> 4 mm →

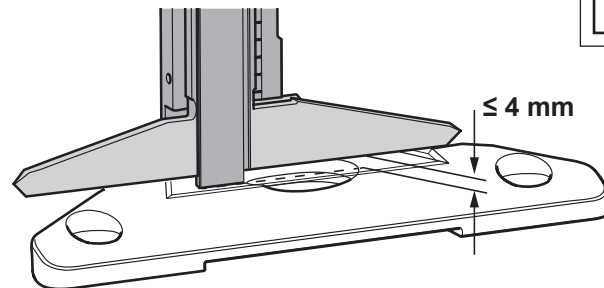
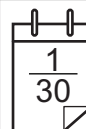

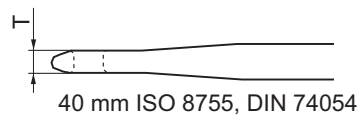
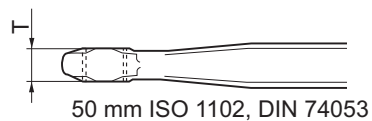
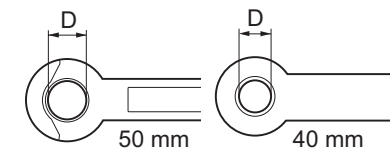

	$\leq D$ (mm)	$\geq T$ (mm)
ISO 50	52	42,5
DIN 40	42	28



Produced in a certified company

VBG GROUP TRUCK EQUIPMENT GMBH · Girmesgath 5 · D-47803 Krefeld
www.ringfeder-rf.com

Member of VBG Group